

TECHNICAL DATA SHEET

SECUMAX 150 MDP NO. 150007

Safety technology

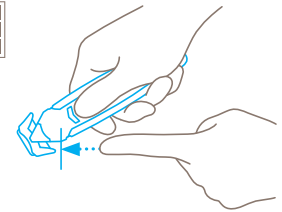

Concealed blade – a maximum degree of safety

The SECUMAX 150 MDP blade is not an open one, but is hidden from people and goods. This provides you with a maximum degree of safety from cut injuries and from damage to goods.



DISPOSABLE SAFETY KNIFE WITH CONCEALED BLADE. FOR CUTTING, SCRAPING AND SCORING.

Order No. 150007.12

Full points in three regards. Metal detectable.

The SECUMAX 150 MDP resolves several issues in one. With its concealed blade, you will never have to worry about injuring yourself or damaging your goods. Thanks to its versatility, you only need the one tool to cut, scrape and split. Main customer benefit: specially designed for sensitive manufacturing processes, the SECUMAX 150 MDP is made of metal detectable plastic to ensure that it is always retrievable.

Metal detectable

You are on the safe side when using the SECUMAX 150 MDP in areas requiring caution. The detectors are effective in the event that the disposable tool – or parts of it – unintentionally enter the production process.

Stainless steel blade

Stainless steel blades are standard in the SECUMAX 150 MDP – optimal for regular use under demanding conditions and for cleaning with water.

3-in-1 blade head

The SECUMAX 150 MDP fits like a glove. It's so comfortable to hold, that it feels like an extension of your hand. With it you can cut cardboard, split tape, open plastic strapping... you can even scrape residue off surfaces.

Concealed blade

This safety knife doesn't need a sharp tip to be a smart knife. The blade is securely concealed so that it presents no risk to you or your goods when opening packages.

Ergonomically shaped

Right handed? Left handed? It's really all the same. Because the SECUMAX 150 MDP perfectly fits any hand – even in gloves. The large handle surface feels particularly pleasant as a secure place for the thumb, fingers and hand.

USAGE

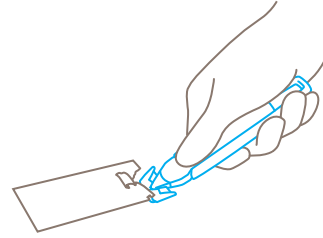
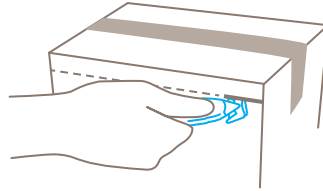
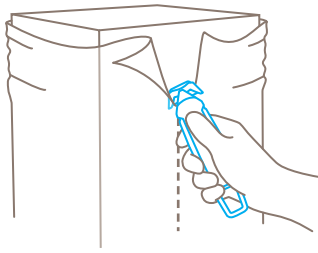

PRODUCT FEATURES

Technical features



Maximum safety



Metal detectable



X-ray detectable



Disposable knife



Very ergonomic



2-cutting edge blade



Cutting depth



Scraper width



Tape splitter



For right and left handers



Lanyard hole



Stainless

Main cutting materials



Cardboard: 1-ply



Wrapping, stretch and shrink foil



Tape



Plastic strapping band



Bagged goods



Layers of foil or paper



Yarn, cord



Felt



Self-adhesive label

Installed blade

Blade thickness 0.30 mm.

BLADE CHANGE

The stainless steel blade is moulded into the body of the knife and cannot be changed.

Blade thickness 0.30 mm.

SERVICES OFFERED



Safety poster



Training video



Technical data sheet



Consulting service

PRODUCT AND PACKAGING DETAILS

Order No.	NO. 150007.12	Packaging unit	10 in box (loose)
Knife size (L x W x H)	148 x 11 x 37.2 mm	Size outer pack	85 x 42 x 150 mm
Weight knife	31.2 g	Weight outer pack	338.0 g
Basic material	Metal detectable plastic	EAN Code outer pack	4002632802409
Cutting depth	6.2 mm	Customs tariff number	82119200

SAFETY CERTIFICATE

Date of issue	15.09.2021
Certification	GS certificate NO. 182389-7404-55094-2021

Certificates and awards



SAFETY ADVICE

To ensure that you use your new MARTOR knife safely and most effectively, please read and note the following user-instructions. Please keep the written guide in a safe place so that you can access it at any time.

1. General application instructions: Please always use the product carefully for manual cutting work only and not for any purposes other than those that are intended. Please take the correct handling and the proper use of the knives into account in this regard. As an additional safety measure, we recommend the wearing of safe gloves.

2. Special application Instructions to avoid the danger of injuries: Only use cutting tools that are in perfect condition and have sharp, clean and undamaged MARTOR blades. Employ the utmost care when handling the knives. Prior to use, familiarise yourself with the safety features and their functioning. Ensure that these safety features are not impaired by the type of material to be cut. CAUTION: The blade is sharp and can result in serious and deep cuts. Therefore, never reach into the blade! Do not place your free hand in the line of cutting and never cut directly towards you.

3. Replacement of spare parts: This knife is a disposable product. It is not designed to have its blades changed or any other of its components replaced. If the knife shows signs of aging or any other wear, e.g. which impair the safety features or usage, the knife must be taken out of service and replaced. Do not modify this product in any way. Modifications of any kind may impair product safety. CAUTION: The risk of injury caused by manipulation of this product is extremely high.

4. Non-use of the knife: Always secure the blade in such a way (depending on product type) that injuries due to cuts are excluded. Store the knife in a secure place.

5. Care instructions: To guarantee a long service life, always keep the knife clean and do not expose it to unnecessary soiling and humidity.

CAUTION: No liability will be assumed for consequential losses. Subject to technical changes and errors! This knife does not belong in the hands of children!

ACCESSORIES

BELT HOLSTER S WITH CLIP NO. 9920



What do you do with your cutting tools when you are not actually using them? The MARTOR BELT HOLSTER S is a robust holder that allows you to carry all compact MARTOR knives as well as our safety scissors at all times. In addition, the compartments are designed to allow you to load different tools: for example you can also carry a pen or a pack of blades. The MARTOR BELT HOLSTER is the ideal place to stow your tools safely when moving from A to B - and have them at hand, as soon as they are required.

MDP TEST CARD SET NO. 9910



There are five cards with different plastic balls in the MDP TEST CARD SET – between 2.5 mm and 8 mm in size. You can reliably test the effectiveness of your metal detectors using the "visiting card".

MANUFACTURER

MARTOR KG | Lindgesfeld 28 | 42653 Solingen | Germany
T +49 212 73870-0 | info@martor.de | www.martor.com